

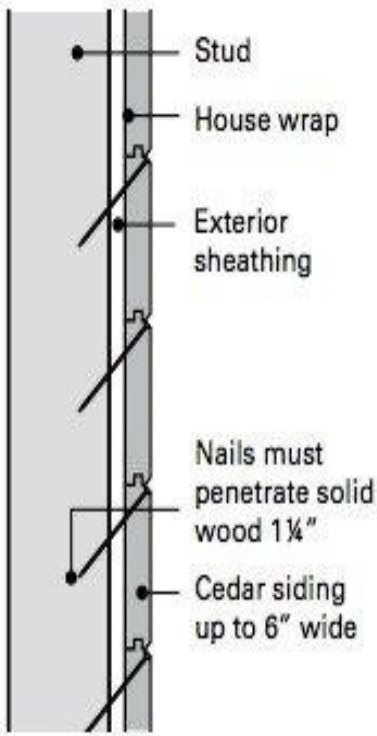

**PEEPLES BROTHERS SUPPLY, INC.**  
**WOOD SIDING INSTALLATION INSTRUCTIONS**  
**Revised 2019**

**2019**



(A) 6" and narrower siding in normal climatic conditions

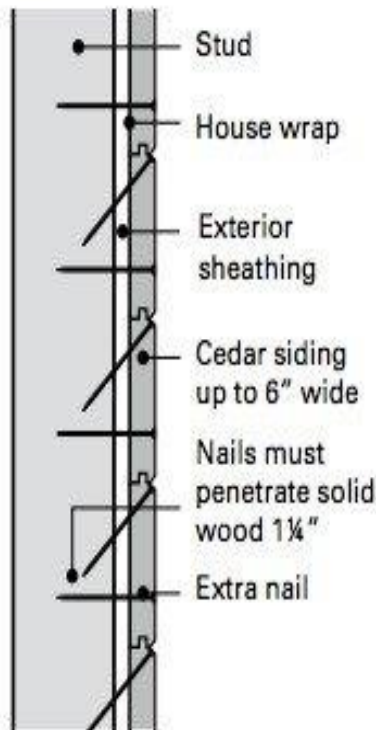

(B) 6" and narrower siding in hot, dry, windy or seacoast climates

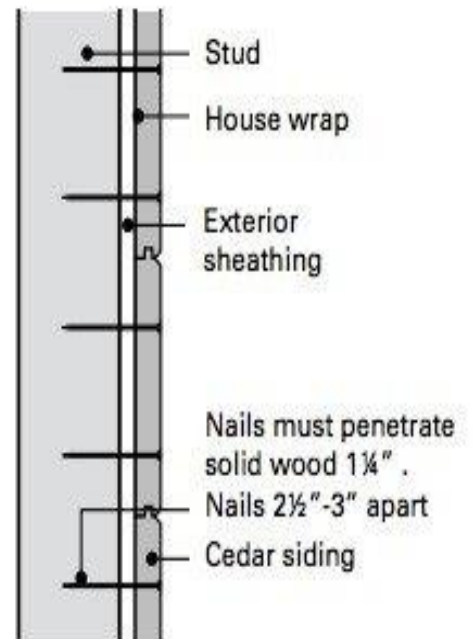

(C) 8" and wider siding

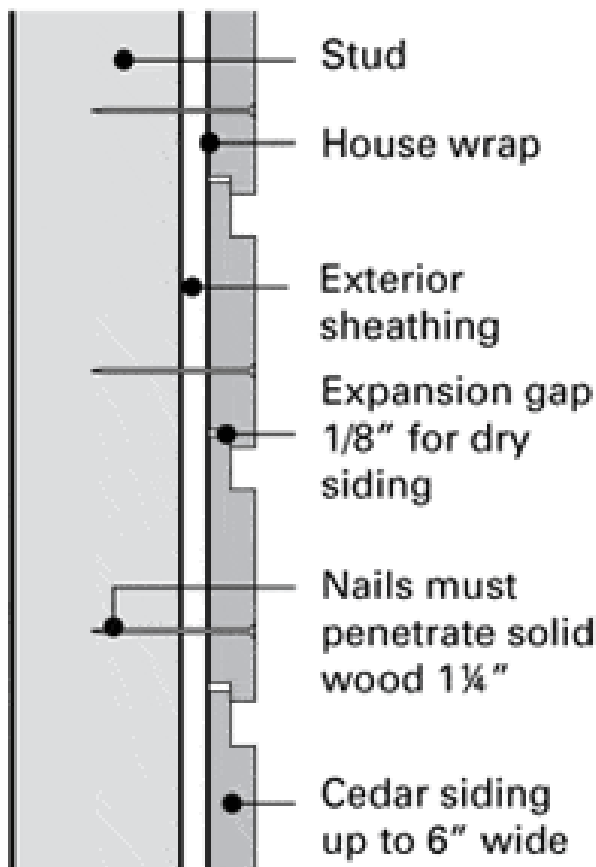

(A) 6" and narrower lap siding

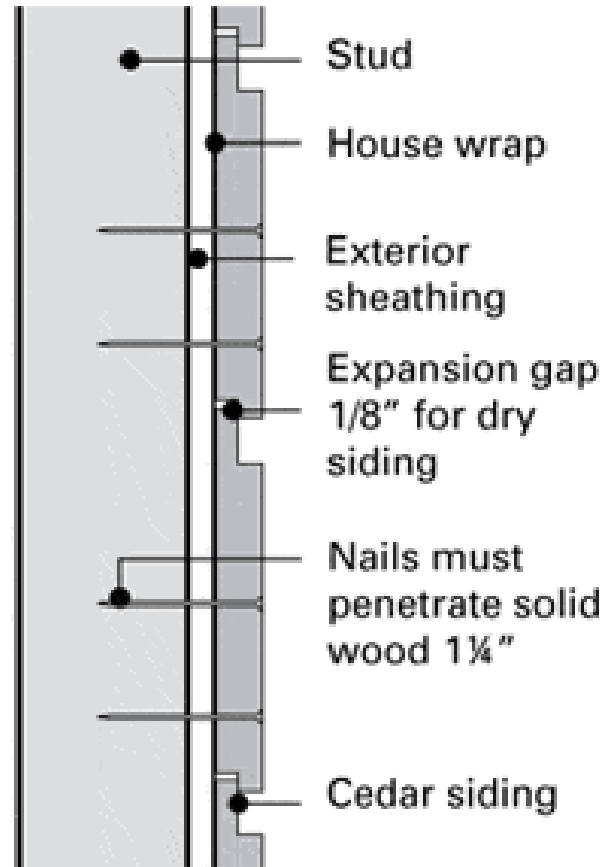

(B) 8" and wider lap siding